

BL Bench Lathe 1/6 Horsepower Order by Part Number Shown in Red

Just 13" Wide... Perfect for Use at the Bench

- 1/6 HP High Torque Motor
- 125 Watts (continuous rating)
- 5/16" Dia. Motor Shaft
- Ball Bearing
- 500-7,000 RPM
- CSA Certified
- CE Rated (230 volt only)
- One Year Warranty



- Weight: 7.5 lbs. (3.4 kg.)
- Width: 13" (330mm) between spindles
- Height-overall: 5 1/8" (130mm)
- Height of spindle center from table surface: 3 3/4" (95mm)

Bench Lathe with Tapered Spindles **M.BL \$199.00**

Powerful variable speed bench lathe in a compact size suitable for use at the workbench. Its permanent magnet motor is extremely quiet and smooth running with all the power and speed required for a variety of polishing and buffing jobs. Cast iron base has mounting holes and suction cup feet for a secure

hold on the work surface. Lathe comes with the TM5 (left hand) & TM6 (right hand) Tapered Spindles for holding buffs and brushes up to 4" (100mm) in diameter. Other lathe accessories are available separately and shown below. Available at same price in **230 Volt**. CE marked. **Specify M.BL-2CE** and power plug option required (see page 5).

Lathe Accessories



Tapered Spindles **\$10 ea.**

- A-TM5** left side for 5/16" shaft
- A-TM3** left side for 1/4" shaft

- A-TM6** right side for 5/16" shaft
- A-TM4** right side for 1/4" shaft

For left and right hand mounting of buffs and wheels up to 4" dia. Also for 3M ScotchBrite™ Radial Bristle Discs and FX Wheels with pre-mounted Spindle Adapters.

Collet Holder with 3 collets **\$29 ea.**

- A-CHA-5** right side for 5/16" shaft
 - A-CHA-4** right side for 1/4" shaft
- Collet holder on arbor comes with 3/32", 1/8" and 1/4" collets, allen key, and pin & wrench for mounting various size shank mandrels, sanding drums, etc. For use only on right hand side. See page 17 for additional collets.

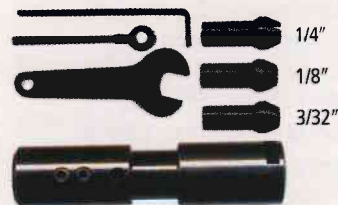

Plastic Spindle Adapters **\$2.00 ea.**

- A-4562** left side
 - A-4561** right side
- For left and right hand mounting of buffs and wheels up to 4" dia. with 3/8" arbor hole. Also for 2" and 3" Scotch-Brite™ Radial Bristle Discs from 3M.



Chuck Arbor **\$45 ea.**

- A-JCA-2** right side for 5/16" shaft
 - A-JCA-1** right side for 1/4" shaft
- Arbor adjusts to hold accessories with shank from 0-5/32". Comes with chuck key. For use only on right hand side.



Hub Adapter for Tapered Spindles **A-4568 \$4.95 ea.**

For left and right hand mounting of FX Wheels from 3M and other wheels with 1" arbor holes. Use on BL lathe spindles and standard tapered spindles.



Wheel Mandrels **\$15 ea.**

- A-WM-5** left side for 5/16" shaft
- A-WM-3** left side for 1/4" shaft
- A-WM-6** right side for 5/16" shaft
- A-WM-4** right side for 1/4" shaft



Hold rubber bonded abrasive wheels, grinding stones, sanding drums, brushes and other accessories with 1/4" center mounting holes up to 3/4" thick.

Dust Collector Hood **MADCH-1 \$49 ea**

Hoods are made of heavy gauge sheet metal construction with non-skid pads on the bottom. Has 2 1/2" (64mm) adapter that fits most collection system hoses. 6 1/2" (165mm) high, 4 5/8" (117mm) wide, and 8 5/8" (219mm) deep.



BL Bench Lathe Kits Order by Part Number Shown in Red



K.BL-DCH \$279.00

Includes BL Lathe with TM5 and TM6 Tapered Spindles and two DCH-1 Dust Hoods. Also available at same price in 230V. Specify **K.BL-DCH-2CE**

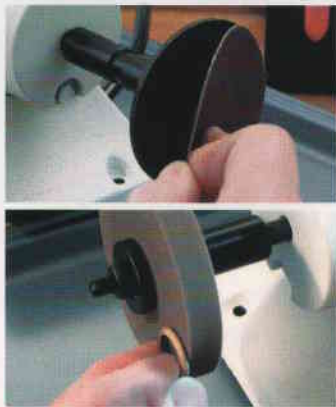

K.3340 \$235

Kit with Collet Holder and Wheel Mandrel



Kit 3340 includes BL Lathe with TM5 & TM6 Tapered Spindles, CHA-5 Collet Holder with 3/32" 1/8", and 1/4" collets, and WM-6 Wheel Mandrel. Also available at same price in 230 Volt. Specify **K.3340-2CE**



K.3396 \$299

Kit with 3M FX Wheels and Scotch-Brite™ Radial Bristle Discs



Kit 3396 includes BL Lathe with TM5 & TM6 Tapered Spindles, plus these 3M products: Four FX Wheels (240, 600, 1,500, & 3,000 grain with one 4568 Hub Adapter), 2" ScotchBrite™ Radial Bristle Discs (5 ea. of 400 grit and 1 micron) with Spindle Adapters (4561 and 4562). Also at same price in 230 Volt. Specify **K.3396-2CE**



K.3390 \$229

Kit with Buffs and Compound



Kit 3390 Includes BL Lathe with TM5 & TM6 Tapered Spindles, Bars of Tripoli, Platinum White & Blue, and Carnauba Wax, 2-4" buffs (CBF4 and CYR4), Four 3" buffs (CBF3, CBC3, CFB3, & LCB3). Also available at same price in 230 Volt. Specify **K.3390-2CE**

